

**WEY MAYENBURG**  
**LAND SURVEYING INC.**

[www.weysurveys.com](http://www.weysurveys.com)

#4-2227 James White Boulevard  
Sidney, B.C. V8L 1Z5  
Telephone (250) 656-5155

BC Land Surveyor's Building Location Certificate On:

Lot 24, Section 22  
Victoria District, Plan 1141  
(P.I.D. No. 007-847-475)

Civic Address: 2460 Central Avenue

This document was prepared for mortgage and municipal purposes  
and is for the exclusive use of our client, MDRN Built Ltd.

This document shows the relative location of the surveyed structures  
and features with respect to the boundaries of the parcel described above.  
This document shall not be used to define property lines or property corners.

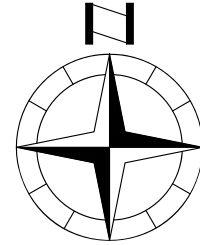

Certified Correct this 3rd day of April, 2019.

Scale = 1:250

Distances shown are in metres.

B.C.L.S. (Not valid unless originally signed & sealed)

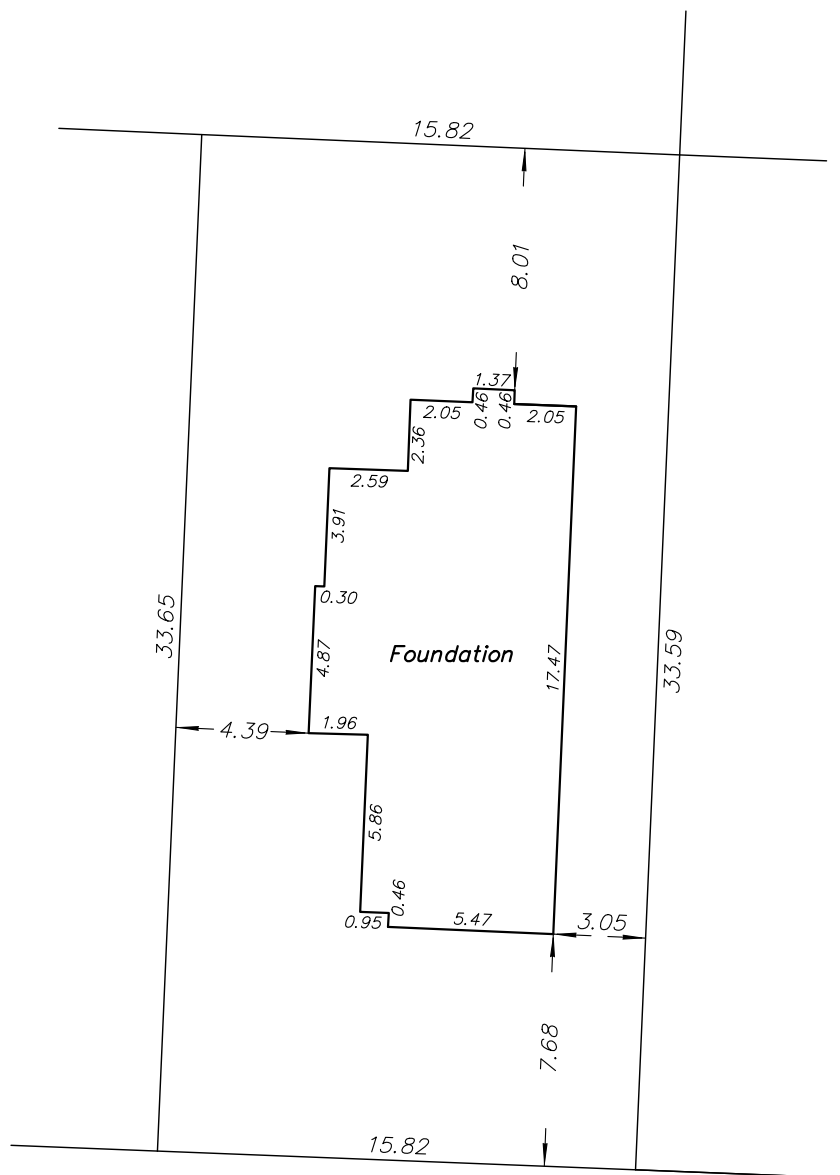

**Central Avenue**